

E-COAT

PV400-7940-31F Electrocoating Ultrafiltration (UF) Element

Product Description

Membrane Material	PVDF
Part Number	PV400-7940AF-WI1H
Membrane Area	287 ft ² (26.7 m ²)
Spacer	31 mil (0.76 mm)
Construction	Fiberglass reinforced epoxy
Permeate O-Ring	EPDM
Seal	EPDM

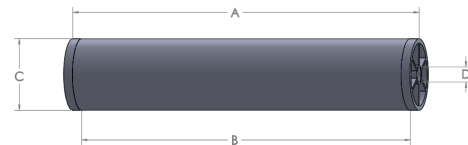

All components of construction are silicone free. This standard electrocoating element can be used with both cationic and anionic paints.

Solecta E-Coat elements are shipped with a 0.5% solution of sodium metabisulfite and need to be flushed with RO/DI water prior to operation.

Physical Dimensions

Length "A"	Length "B"	Element OD "C"	Permeate Tube ID "D"
40 in (1016 mm)	38 in (965 mm)	7.88 in (200 mm)	1.139 in (28.9 mm)

Operating Parameters

Maximum Inlet Pressure	Minimum Outlet Pressure	Maximum Permeate Pressure	Maximum Feed Side Pressure Drop	Maximum Operating Temperature	pH Range
70 psi (4.9 bar)	10 psi (0.69 bar)	5 psi (0.34 bar)	35 psi (2.4 bar)	120° F (49° C)	CIP: 1.8 - 10.5 Operation: 2-10